

USINAGE LAQUERRE & FILS

UNIVERSAL WATER SWIVEL

ASSEMBLY

Description	Part N°.	Weight	
		lb	kg
Universal Water Swivel Assy BW Rod Box	70-15-100	31.50	14.3

Rotating Capacity: 11 000 lbs / 5 000 kg
Static Capacity: 25 000 lbs / 11 400 kg

Repair Kit Universal	70-15-150	~	~
- Ball bearing (1)			
- Internal retaining ring (1)			
- "O" Ring (1)			
- Spindle extension (1)			
- "V" packing set (1)			
- Locking washer (1)			
- Ball bearing thrust (1)			

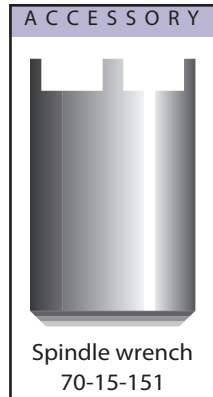
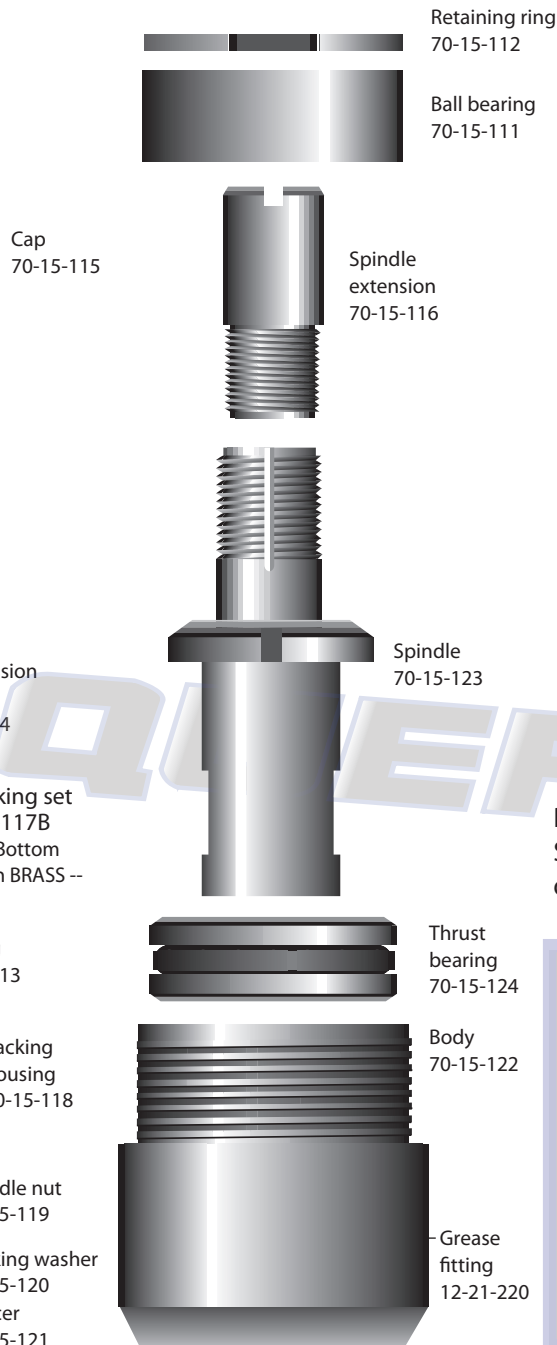

ROD ADAPTORS ;
Subs with O'ring
or bullnose too available.

W/L	Standard	Part N°.
Rod Pin	Rod Pin	
A W/L	BW	34-36-006
B W/L	BW	34-36-106
N W/L	BW	34-36-206
H W/L	BW	34-36-306
P W/L	BW	34-36-406

Thin Wall	Standard	Part N°.
Rod Pin	Rod Pin	
ATW	BW	34-65-006
BTW	BW	34-65-106
NTW	BW	34-65-206